



ADT Pulse Mobile App - Modes

"Modes" enables total home automation at the touch of a button, providing greater security, control, and energy savings. You perform a single action—select a new mode—and settings for lights, thermostats, locks and so forth are automatically changed to values that you specifically programmed for the selected mode. The user-definable modes enable schedules and automations to perform actions with respect to your security system's arm state, scheduled times, sensor status, system events, and more.

Note: The ADT Pulse Mobile App can only be used to select Modes that have been set up using the Web Portal. You cannot set up Modes with the mobile app.

Using Modes you can set up custom automations and schedules for the ultimate amount of control. For example, when leaving on vacation, arm your system and then select the On Vacation mode. The following actions can occur automatically:

- Change the thermostat schedule to an energy-efficient schedule
- Turn off all lights and lock all doors
- Enable a schedule that randomly turns on certain lights between 7pm and 10pm
- Capture video clips from all cameras if motion is detected
- Send an alert when the system is disarmed (for instance, to ensure that your pet sitter is caring for the family pet)

Upon returning home, you disarm the system and change the system to an At Home mode. Your system reverts back to the pre-defined settings and schedules associated with the selected mode. Alternatively, you can use the mobile application to change the mode on your way back from the airport, to get your home ready for your arrival, without compromising your home's security.

Switching Modes

The Modes feature allows you to change the behavior of your home or business automation devices based on modes, for example, At Home or Be Right Back.

Note: Modes uses alerts, automations, and schedules to customize the behavior of your home using installed sensors, cameras, and Z-Wave devices. When a particular mode is active, it determines which alerts, automations, or schedules are active and can occur. For more information about using modes, refer to "About Modes" in the online help for the web portal.

To change Modes:

1. Tap Modes on the Dashboard. The Modes screen appears. On this screen, you can view the mode that is currently active, indicated by the circled check mark to the right of the Modes name. In the following illustration, At Home is selected.

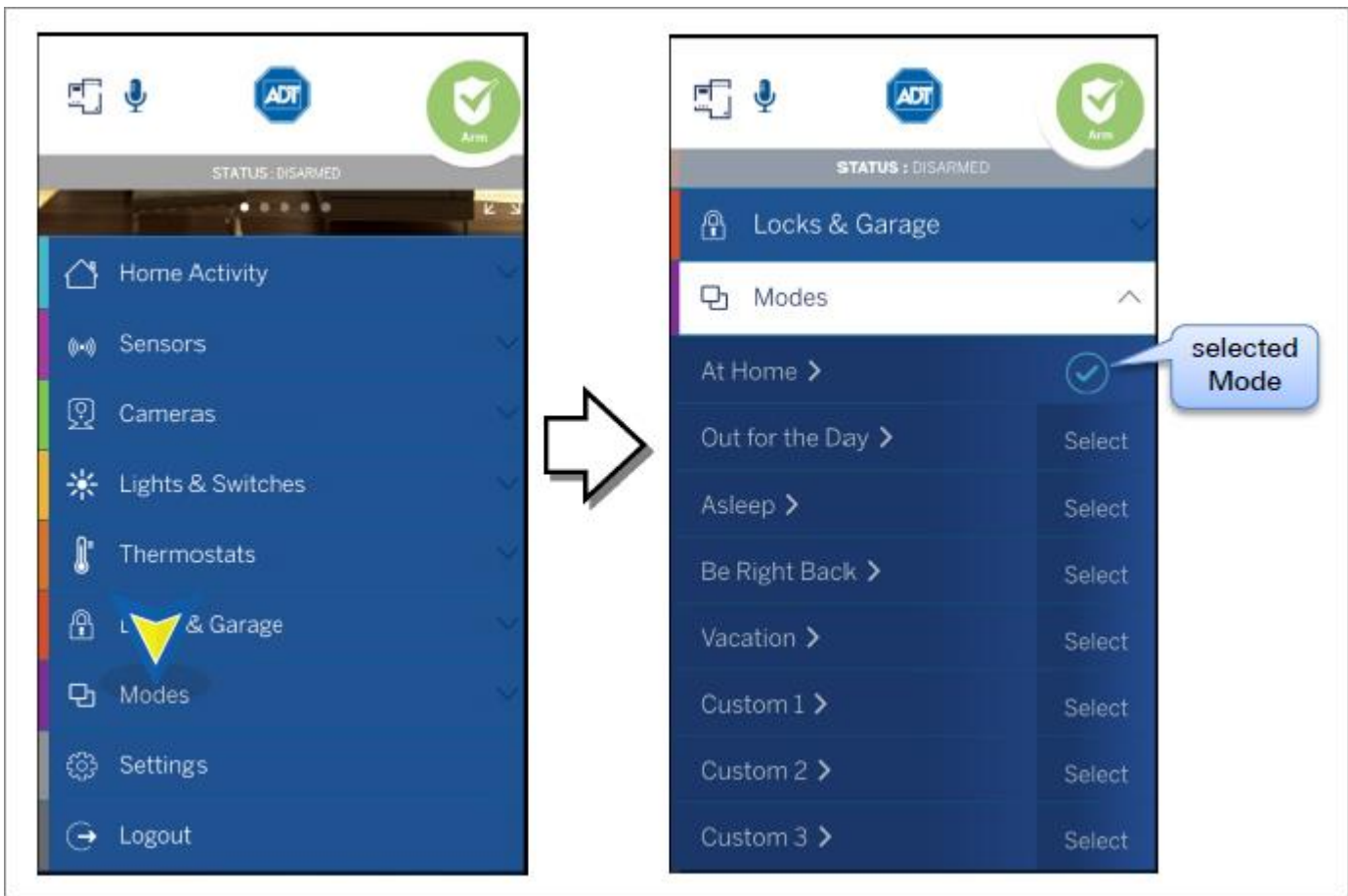

2. To switch Modes, select the desired mode. The circled check mark moves to the right of the selected mode, indicating that this mode has become active.

To get step-by-step instructions, review the ADT [Pulse Mobile App User Guide](#) (7MB). For more precise questions, check out our ADT [Pulse Mobile App](#) page.

